

소요수명				품번	품명	재질	규격	비고
G04	G03	G02	G01	ITEM	DESCRIPTION	MATERIAL	SPECIFICATION	REMARK
			1	01	Out Line		APM-EEP09A/06D/05G/03MM3N2	무Key, Brake Type
		1		02	Out Line		APM-EEP15A/11D/09G/06MM3N2	무Key, Brake Type
	1			03	Out Line		APM-EEP22A/16D/13G/09MM3N2	무Key, Brake Type
1				04	Out Line		APM-EEP30A/22D/17G/12MM3N2	무Key, Brake Type

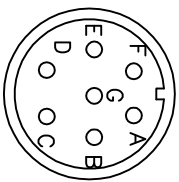
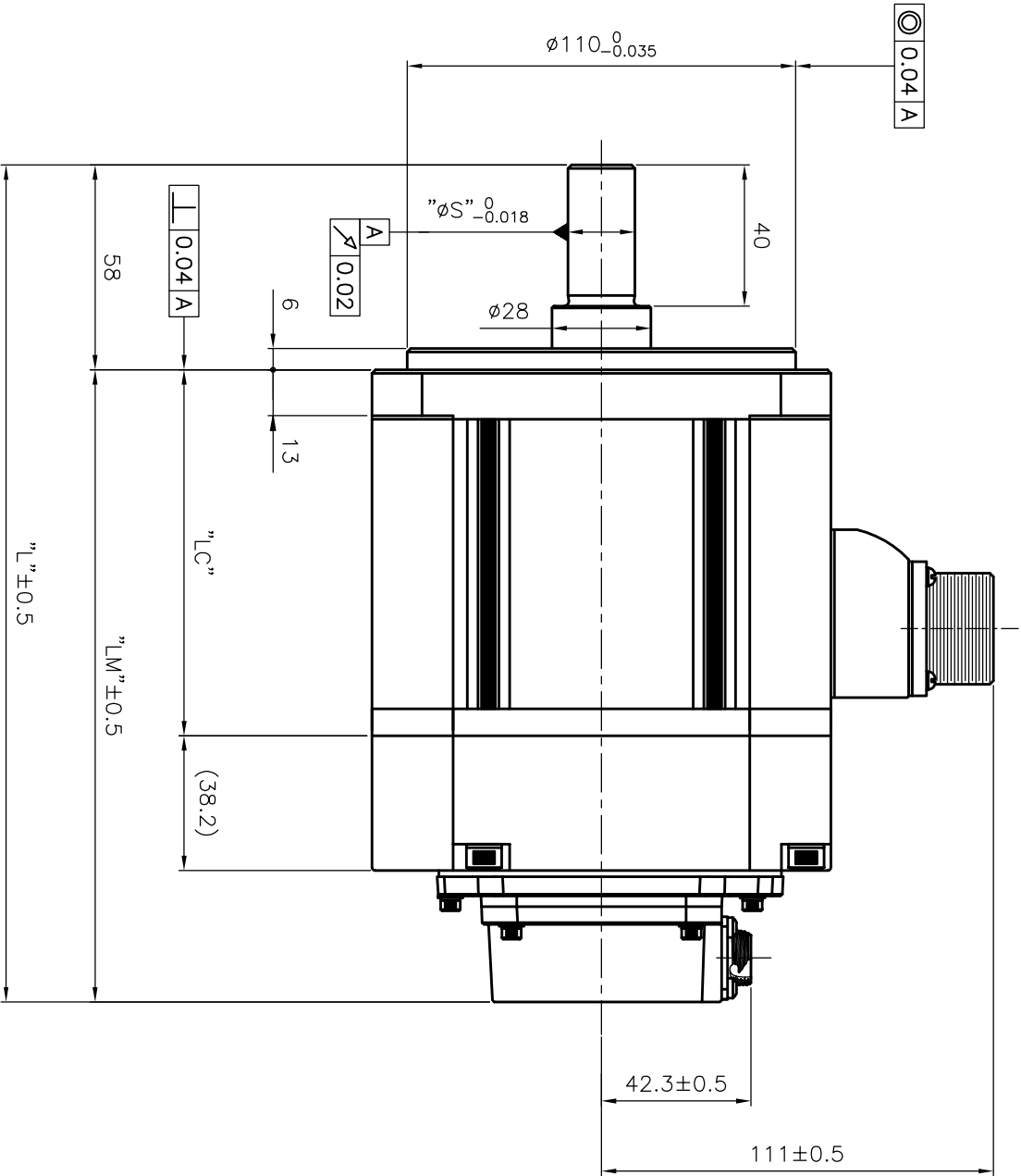
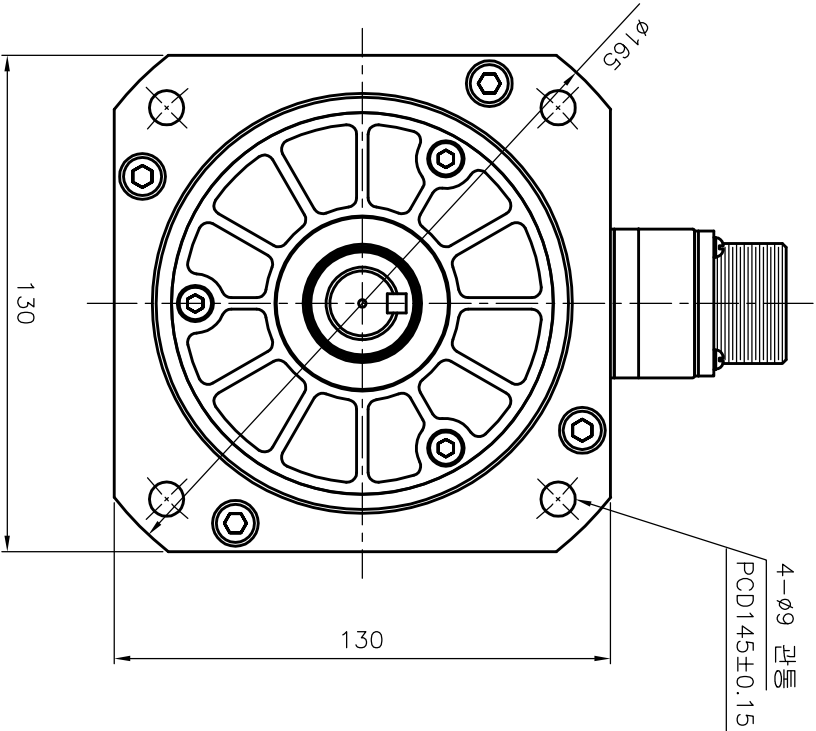

Pin No.	Phase
A	U
B	V
C	W
D	FG
E	BK+
F	BK-

MS3102A20-15P
(7 pole plug)

<Power Connector 핀 배열>

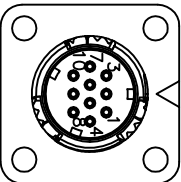

Pin No.	Encoder Phase	Pin No.	Encoder Phase
1	+5V	6	MA
2	0V	7	MA
3	-	8	SLO
4	VDD_B	9	SLO
5	GND_B	10	SHIELD

SC-CMV1-R10PTG-4
(10 pole plug)

<Encoder Connector 핀 배열>

<외형 치수>

군 번	모델명	L	LM	LC	S	T	W	U	중량(kg)
G01	APM-EEP09AM3N2								
	APM-EEP06DM3N2	219	161	85.6	19	5	5	3	6.3
	APM-EEP05GM3N2								
	APM-EEP03MM3N2								
G02	APM-EEP15AM3N2								
	APM-EEP11DM3N2								
	APM-EEP09GM3N2	237	179	103.6	19	5	5	3	7.8
	APM-EEP06MM3N2								

군 번	모델명	L	LM	LC	S	T	W	U	중량(kg)
G03	APM-EEP22AM3N2								
	APM-EEP16DM3N2	255	197	121.6	22	6	6	3.5	9.4
	APM-EEP13GM3N2								
	APM-EEP09MM3N2								
G04	APM-EEP30AM3N2								
	APM-EEP22DM3N2								
	APM-EEP17GM3N2	273	215	139.6	24	7	8	4	11
	APM-EEP12MM3N2								

무지정 공차		기타 공차	
치수 구분	치수	구분	공차
~3mm	0이하		±0.10
3~6mm	0이하		±0.12
6~10mm	0이하		±0.15
10~18mm	0이하		±0.18
18~30mm	0이하		±0.21
30~50mm	0이하		±0.25
50~80mm	0이하		±0.30
80~120mm	0이하		±0.35
120~180mm	0이하		±0.40
180~250mm	0이하		±0.46
250~315mm	0이하		±0.52
315~400mm	0이하		±0.57
400~500mm	0이하		±0.63
500mm 초과			±0.70

개

CHANGE

정

1

2

3

4

5

설계

DESIGNED

검토

CHECKED

승인

APPROVED

2023.04.06

도면명칭

Out Line (무Key, Brake Type)

도면번호

DWG. NO.

EMP13GA004

1/1

Ver

1.0

LS Mecapion

제품명

AP13 Servo Motor