

--

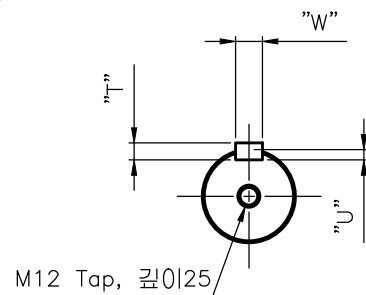

A diagram of a circular cell. The cell is bounded by a double-line circle. Inside, there are four organelles represented by small circles with internal structures. Organelle A is in the top right, containing a single dot. Organelle B is in the bottom right, containing a single dot. Organelle C is in the bottom left, containing a single dot. Organelle D is in the top left, containing a single dot. A small rectangular notch is located at the top center of the cell boundary.

Pin No.	Phase
A	U
B	V
C	W
D	FG

Pin No.	Encoder Phase	Pin No.	Encoder Phase
A	MA	M	—
B	MA	N	—
C	SLO	P	—
D	SLO	R	—
E	VDD_B	H	+5V
F	GND_B	G	0V
K	—	J	SHIELD
L	—		

A diagram of a circular arena used for the experiment. It consists of a large outer circle and a smaller inner circle. The space between the two circles is divided into three equal sectors by three radial lines. The top sector is labeled 'A', the bottom-left sector is labeled 'B', and the bottom-right sector is labeled 'C'. A small square notch is located at the top of the inner circle, centered within sector A.

Pin No.	Phase
A	BK+
B	BK-
C	-

무지칭 공차	
치수 구분	기본 공차
~3mm 이하	±0.10
3~6mm 이하	±0.12
6~10mm 이하	±0.15
10~18mm 이하	±0.18
18~30mm 이하	±0.21
30~50mm 이하	±0.25
50~80mm 이하	±0.30
80~120mm 이하	±0.35
120~180mm 이하	±0.40
180~250mm 이하	±0.46
250~315mm 이하	±0.52
315~400mm 이하	±0.57
400~500mm 이하	±0.63
500mm 초과	±0.70

개 CHANGE	1	2	3	4	5	<div>LSMecapion</div>	삼 각 법 3RD ANGLE PROJECTION	척 도 SCALE 1/1 . (N.S)	제 품 명 PRODUCT NAME	AP22 Servo Motor		
							단 위 UNIT MM	일 자 DATA 2018.11.01	도면명칭 TITLE	Out Line (Key, Brake, OilSeal Type)		
						설 계 DESIGNED	검 도 CHECKED	승 인 APPROVED	도면번호 DWG. NO.	FM22GA007-4	1	1
									참조도면 REF. NO.		Ver	1.0